



**Assist - Your French Concierge**

# TABLE OF CONTENTS

Bonjour

## PAGES

3

**YOU'RE IN SAFE HANDS!**

5-7

**RELOCATION PACKAGES**

8

**OFFICIAL TRANSLATION SERVICE**

9-11

**PRACTICAL SUPPORT:**

- **HEALTH**
- **EDUCATION**
- **INSURANCE**

12-14

**DRIVING IN FRANCE**

15-15

**ARCHITECTURAL AND PLANNING SERVICE**

19-20

**STARTING A BUSINESS IN FRANCE**

21

**TAX SERVICE**

22

**LEARNING THE LINGO AND LESSONS**

23-25

**YOUR CONCIERGE TEAM**

\*Assist - Your French Concierge is not responsible for the content, accuracy, or reliability of any information provided by third-party websites. Accessing such sites is at your own risk

\*\*Our service packages and pricing may evolve over time as we continue to expand and improve our offerings. While we strive to keep all information up to date, prices are subject to change based on the development of new services, market conditions, or client-specific needs.  
For the most accurate and tailored quote, please contact us directly.

# Simplify Your Move with Assist - Your French Concierge

You're in safe hands!

Bonjour! We are Claudia and Natalie, partners at Assist.



- Together, we have enjoyed living in France for a combined total of 25 years and have happily settled here with our families.
- Having personally experienced the journey from the UK to France, we understand the challenges of enrolling our children in schools, navigating French bureaucracy, establishing successful businesses, and forming meaningful connections within our French communities.
- Over the past three years, our French hand-holding services have expanded rapidly as more individuals seek our support to make their transition to France smoother.
- We have dedicated ourselves to building a team of bilingual specialists who can help turn your dreams into reality, and we are excited to present our range of support packages.





# RELOCATION PACKAGES

# VISAS

## Short-Stay vs. Long-Stay Visas

If you're from the UK or a non-EU country, you'll need a visa for stays over 90 days.

The long-stay visa (VLS-TS) allows you to stay for a year and must be validated within three months of arrival.



## Residency Permits (Carte de Séjour)

After your first year, you must apply for a carte de séjour at the prefecture.

Different permits exist for retirees, employees, self-employed individuals, and business owners.

## French Language Requirement

Some visas require proof of basic French (A1 level).

Learning French before moving will help with daily interactions and administration.

\*Please note that visa and residency requirements, including language proficiency rules, can be subject to change. We recommend checking official government sources

<https://etrangers-en-france.interieur.gouv.fr/>

*If you wish to apply for your visa without our assistance, click below:*

**[French Consulate in London website.](#)**

Ensure you have the relevant information to hand before starting your application.

# VISAS PACKAGES

## Retired | No right to work in France

### Our Support Package includes:

- Visa application (support with TLS Contact)
- Carte Vitale
- Bank account
- Visa validation in France
- 30-minute French taster lesson

### Package Costs:

**Individual - Retired | No right to work**

**750 euros \***

**Couple - Retired | No right to work**

**995 euros \***



  
*La belle vie*

---

## **6-month Tourist Visa Support**

**Individual - 150 euros\***

**Couples - 225 euros\***

Note\* These costs do not include additional charges incurred from TLS in the UK



# VISAS PACKAGES

## Right to work Visa - Individuals, Couples & Families

### Our Support Package includes:

- Visa application (support with TLS Contact)
- Carte Vitale
- Bank account
- Visa validation in France
- Tax Consultation (Max 45-minutes)
- 30-minute French taster lesson
- Locating nearest school and email introduction template provided

Bonjour

*Business plan support can be provided at an additional cost\*\**

### Package Costs:

#### Individual - Right to work Visas

**1100 - 1200 euros \***

depending on visa type (entrepreneur or talent)

#### Couple - Right to work Visas

**1345 - 1550 euros \***

depending on visa type (entrepreneur or talent)

**\*\* Note: Business Consultation included with talent visa applications.**



---

## Additional Children

**160 euros \***

Note\* These costs do not include additional charges incurred from TLS in the UK

# OFFICIAL TRANSLATION SERVICE

In France, many administrative procedures, such as applying for a visa or registering a civil partnership, require official documents like birth certificates or driving licences.

If these documents are not in French, they may need to be translated to be accepted by the authorities.

In such cases, the translation must be done by a traducteur agréé (also known as a traducteur assermenté or traducteur expert), a translator officially recognised by the French legal system.

Only translations completed by these certified professionals are considered valid for administrative purposes.

At Assist, we have a traductrice/interprète available to handle any paperwork that requires official translation. Price upon request.







# Factures électricité



# Factures Gaz



# PRACTICAL SUPPORT

# PRACTICAL SUPPORT

We can help you deal with the essentials when setting up a home in France.

Whilst these tasks might seem easy to manage in your home country, they can be a little trickier when language is a barrier.

## We can help with:

### Insurance quotes

*(health, home, school and business)*

- 1 x quote **€40**
- 2 x quotes **€70**
- 3 x quotes **€90**
- 4 x quotes **€110**

### Setting up utilities

- **€60** per utility (to open contract)
- **€50** per hour for issues, problems with suppliers, over-billing problems and so on.

To open a utility account, you will need a bank account (RIB), mobile and email contact, and other information dependent on the utility. We can guide you on this.



### Education and Family Life

We can identify schools in your area and provide you with a template for an introductory email to your preferred institutions. Find out more about the French school system [here](#)

### Family Benefits

Families residing in France may be eligible for benefits from the Caisse d'Allocations Familiales (CAF), which offers support for childcare and housing. Eligibility is determined by factors such as income, family size, and residency status. To find out more click on [CAF](#) (Caisse d'Allocations Familiales)

# PRACTICAL SUPPORT

## Support with the Language

If French is not your first language or you find it difficult to make appointments on the phone or in person, we can assist. If you haven't found a doctor, dentist, or bank, then let us help you find an English-speaking service, where available, in your area that you can feel confident accessing. For local appointments, our bilingual associate can be there to help interpret to ensure important information is understood.

We charge **€42 – €50** per hour + travel



## French Healthcare (Assurance Maladie)



### Registering for French Healthcare

After residing in France for three consecutive months, you are eligible to apply for state healthcare through the Carte Vitale system. This system typically reimburses around 70% of standard healthcare costs.

Many residents opt for complementary private health insurance, known as a "mutuelle" to cover the remaining healthcare expenses not reimbursed by Assurance Maladie. This additional coverage can significantly reduce out-of-pocket costs.

### Doctors and Pharmacies

When visiting a doctor, patients generally pay upfront for the consultation. Assurance Maladie reimburses approximately 70% of the standard consultation fee, with the remaining balance potentially covered by your mutuelle or paid out-of-pocket.

Pharmacies are widely available throughout France. The state partially reimburses the cost of prescription medications, with the remaining amount often covered by your mutuelle, depending on your specific insurance plan.

Find out more about healthcare in France [here](#)



# DRIVING IN FRANCE

## Exchanging Your UK Driving Licence

As of January 1, 2021, following Brexit, UK driving licences are recognised in France for short visits. However, if you become a resident in France, you are required to exchange your UK licence for a French one. The process involves submitting an online application to the French authorities and providing necessary documentation, such as proof of identity, residency, and your current UK licence.

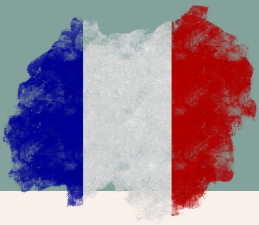

# DRIVING IN FRANCE

## Essential Tips for Driving in France

- **Speed Limits:** Under normal conditions, the standard speed limit on French motorways (autoroutes) is 130 km/h. This is reduced to 110 km/h in wet weather and 50 km/h in heavy fog or icy conditions.
- **Toll Roads:** Many French motorways are toll roads. Be prepared to pay tolls either in cash or by credit card.
- **Priority to the Right:** At intersections without traffic signs, vehicles approaching from the right have priority. This "priorité à droite" rule is unique and may differ from UK driving norms.
- **Safety Equipment:** Carrying a warning triangle and a high-visibility vest in your vehicle is mandatory. In the event of a breakdown, you must wear the vest and place the triangle at a safe distance behind your vehicle to warn other drivers.
- **Mobile Phone Use:** Using a handheld mobile phone while driving is strictly prohibited and subject to fines.

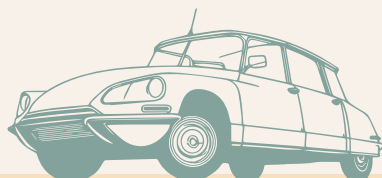

- **Driving in Cities:** Some cities in France have implemented limited traffic zones (LTZ), restricting motorised vehicles without valid reasons for entry. This measure aims to improve air quality and reduce congestion. If you plan to drive in these cities, ensure you know these restrictions to avoid fines. To find\_out more [click HERE](#).
- **Roundabouts:** When approaching a roundabout, vehicles already circulating have the right of way. Yield to traffic coming from your left unless otherwise indicated.
- **Alcohol Limits:** The legal blood alcohol limit in France is lower than in the UK. It's 0.05% for most drivers, and for bus and coach drivers, it's 0.02%. Always ensure you're within the legal limits to maintain safety and compliance.
- **Seat Belts:** Wearing seat belts is compulsory for all passengers in front and rear.

Adjusting to these regulations will ensure a smooth and safe driving experience in France. Always stay updated on local laws and customs, as they can evolve over time.

# DRIVING IN FRANCE

## SERVICES

We assist with all aspects of vehicle ownership in France:

- Buying a car & registration: €200
- Selling a car: €150
- Registering a purchased vehicle: €120
- Change of address on Carte Grise: €60
- UK to France driving licence exchange: €180
- Importing a car from the UK: Price on application





# ARCHITECTURAL AND PLANNING SERVICES

# ARCHITECTURAL AND PLANNING SERVICES

If you're planning renovations or construction in France, you'll almost certainly need planning permission for the work you intend to do.

Planning permission is required for projects such as installing a Velux window in the roof, replacing old windows with double-glazed ones, adding a kitchen extension, transforming a barn into a living space, or even installing a swimming pool in your garden.

The zoning plan for your property (PLU) will indicate what is permitted and what is not. Restrictions may apply if your house is located in a historic area (e.g., near a church) or in an agricultural zone.

Depending on the work you intend to carry out, you will need either a DP (Déclaration Préalable) or a PC (Permis de Construire).

Additionally, if your home has more than 150 m<sup>2</sup> of habitable space, you will need to submit the plans to a French-registered architect.

Our English-speaking planning consultants and architects can help you achieve your dream project.

Geraldine is an interior architect and technical drafter who can assist with small renovation projects up to 150 m<sup>2</sup>.

Tom is an English architect registered in France who can provide full design and planning services for any size project anywhere in France.

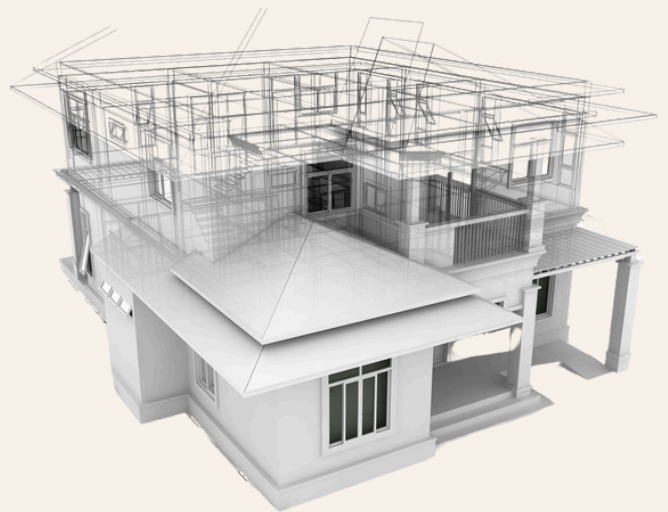

**A full list of costs can be found on page 18.**



# ARCHITECTURAL AND PLANNING SERVICES

Please take a read of **French Plans - FRENCH PLANNING AND ARCHITECTURAL SERVICES** helpful guides and downloadable **PDFs**.

<https://www.frenchplans.com/french-planning-faq>

[Guide to Planning in France](#)

<https://www.frenchplans.com/renovateornewbuild>

## **Planning application types in France**

<https://www.frenchplans.com/brief-guide-to-planning-permits-in-france>

<https://www.frenchplans.com/swimming-pools-in-france>

<https://www.frenchplans.com/renovating-your-chateau>

<https://www.frenchplans.com/post-approval-planning-notice>

<https://www.frenchplans.com/setting-up-equestrian-centres>

<https://www.frenchplans.com/guide-to-campsites-and-yurts>

<https://www.frenchplans.com/3-things-to-think-about>

<https://www.frenchplans.com/quick-guide-to-barn-conversions>

<https://www.frenchplans.com/renovating-your-chateau>

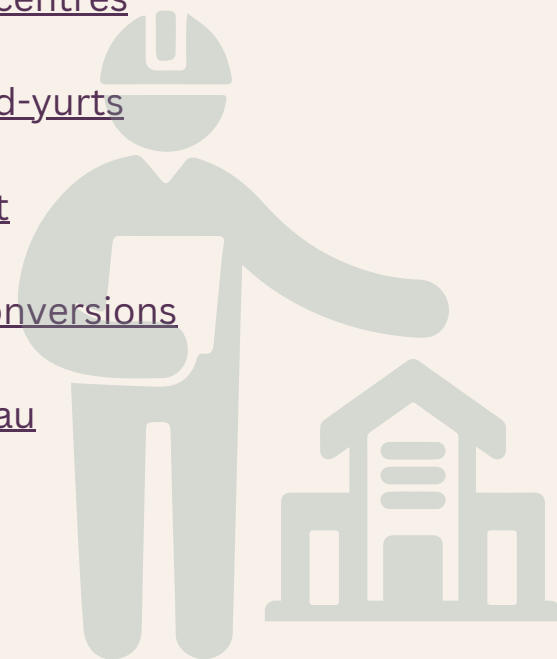

# ARCHITECTURAL AND PLANNING SERVICES

Every project is unique - whether it's a minor renovation or a large-scale build, and/or it is located in a historical area, pricing can vary. We can provide a tailored quote based on your specific needs.

To give you a general idea, here are some indicative price ranges:

## **Outline planning (Certificat d'Urbanisme - CU)**

€400 - €825

## **Minor works (Declaration préalable - DP)**

Swimming Pool €725 - €1100

Other minor works e.g. change of window or new roof €350 - €900

Larger-scale minor renovations e.g. extension less than 20 m<sup>2</sup> €650 - €1400

## **Full planning permission (Permis de construire - PC) less than 150 m<sup>2</sup>**

Renovation / Conversion / Extension: €1800 - €2500

## **Full Planning Permission (Permis de Construire - PC) more than 150 m<sup>2</sup>**

Renovation / Conversion / Extension €3400 - €4400

New Build €3000 - €3850

Feasibility Studies: €350 - €800

Project cost summary €450 - €1000

## **Additional reports:**

Etude du sol / fosse survey €475 - €950

Etude de Sol / Structural soil test €1100 - €2000

Thermal Report (RE2020) Price on application

\*Division of land - Other project and design elements / Commercial projects  
(including ERP / Fire and accessibility compliance)

**Subject to individual quotation**





# STARTING A BUSINESS IN FRANCE

The auto-entrepreneur (now also known as micro-entrepreneur) regime is a simplified system for starting a business in France. Taxes are based on turnover, and social contributions are paid either monthly or quarterly.

If you would like help setting up a business in France, let us simplify the process for you.

We can assist you in registering your business as a Micro-entreprise (ME) and obtaining your SIRET number, allowing you to focus on growing your business.

# START YOUR BUSINESS IN FRANCE

## Individual Business Registration

€250 (ME only)

Includes:

- Registering your business according to the activity you have chosen
- Assisting you with the necessary documents you need to provide
- Making an appointment for you with the relevant business formality centre, if required

**For business activities outside of ME registration, please enquire about pricing.**

## Additional business support

- Assistance with registration with URSSAF/Impôts/Médiation de la consommation **€80 each**
- Formatting your invoices and estimates with legal notices **€80 each**
- Initial CFE (Cotisation foncières des entreprises) declaration **€80**
- Turnover declaration **€45.00 per declaration**
- Daily help with your invoicing/quotes **€45 per hour**

## Business Marketing and Publicity - Gîtes, Chambres d'hôtes and much more!

Stand out with our tailored marketing solutions:

- Website design and web shop creation
- Social media marketing kits
- Branded invoices, brochures, and letter templates
- Business launch strategy and content writing

Contact us for a personalised quote!

[info@assistvirtualsupportolutions.com](mailto:info@assistvirtualsupportolutions.com)





# TAX AND INVESTMENTS

Our bilingual associate Tax Advisor has over 20 years of professional experience in France, assisting clients with understanding the French tax system. They regularly provide support on fiscal matters, business guidance, completing annual tax declarations, and advising on the potential tax implications of foreign income and investments.

Some of our visa packages include a tax consultation, but if this is not part of the package you selected, we can provide a competitive price upon request.

If you would like to read more about the French tax system, click [here](#)



# LEARNING THE LINGO!

If you want to prepare for your new life in France, we highly recommend taking French lessons before arriving.

In addition to using learning apps, try listening to podcasts, watching French TV, or enjoying your favourite series in French.

At Assist, we've got you covered with our in-house bilingual language facilitator, who can provide lessons at any level for you and/or your family before and after arriving in France. Alternatively, you can attend one of our 5-day intensive language workshops in Bellac (87).

If you would like to take a 30-minute French taster lesson to assess your level and specific needs, we can arrange this, along with ongoing lessons.

Read our French blog here:



**[Lost in Translation: The Importance of Learning French Before Moving to France](#)**



# MEET THE CONCIERGE TEAM



## **Claudia Ryan-Jones - Partner**

With over 20 years of business experience, Claudia dedicates her expertise to supporting individuals and families moving from the UK to France. She focuses on ensuring a smooth and efficient transition, providing a stress-free experience from the initial planning stages to the moving day.



## **Natalie Hodencq - Partner**

With 20+ years of living in France and 10+ years of VA experience across multiple industries, Natalie is highly organised and has a keen expertise in IT. She brings precision and adaptability to every task and provides top-tier project management to support all aspects of your new life in France.



### **Angèle Jeannot**

Angèle is fully bilingual and can help you navigate the French administration systems, including setting up your own business, registering for a Carte Vitale, and any car-related services.



### **Wil Schmitz**

Wil is Dutch and fluent in English, with 20+ years of experience in creating professional websites, blogs, and web shops. Wil can support many other business design needs in terms of logo, corporate identity, and the realisation of printed matter.



### **Geraldine van Rijs**

Geraldine speaks Dutch, French, and English and is an interior designer with more than 25 years of experience, and can assist with interior design, layout advice, home staging, and advice and guidance on renovation projects of 150 m2 and less.



### **Katey Green**

Katey is an experienced bilingual hand-holder who can provide extensive support with Visa applications. She also has a wealth of knowledge of the French health system and business setup and administration in France.



### **Annabelle Surch-Williams**

Annabelle is bilingual and helps non-French speaking clients with in-person interpretation services such as doctors appointments, translation, admin support, one-to-one French language lessons, and 5-day intensive language workshops.





### **Lindsey Queriad**

Lindsey is a bilingual Tax Advisor with over 20 years of professional experience in France, assisting clients with their understanding of the French tax system. Regularly assisting with fiscal issues, business support, completion of annual tax declarations, or understanding of the eventual tax implications on your foreign incomes and investments.



### **Tom Easdown RIBA CROA - French Plans**

Tom runs an experienced team of bilingual architects who can work with you to develop design proposals and produce all the drawings and documents required for planning application submissions. Tom and his team will then submit and manage the application process for you and assist with all the necessary administration once your application is approved.



### **Claudine Scott**

Claudine Scott is a court appointed translator and has been working in this role since 2010. In many French administrative procedures, the "certified" or "sworn" translation of your documents written in another language is mandatory. Claudine can assist with this.

**Contact us to begin your journey**  
**[info@assistvirtualsupportsolutions.com](mailto:info@assistvirtualsupportsolutions.com)**

